

SLG - 2Q - 250 - 25

工厂代号 Factory Code

规格代号 Specification Code

2Q: 二位二通气控阀  
Two Position Two Way Air Control Valve

流量口径 Aperture of Flow Rate

- 160: 16mm
- 200: 20mm
- 250: 25mm
- 350: 35mm
- 400: 40mm
- 500: 50mm

接管口径 Joint Pipe Bore

- 10: 1/4"
- 15: 1/2"
- 20: 3/4"
- 25: 1"
- 35: 1 1/4"
- 40: 1 1/2"
- 50: 2"

技术参数 Specification

型号 Model	SLG-2Q160-10/15	SLG-2Q200-20	SLG-2Q250-25	SLG-2Q350-35	SLG-2Q400-40	SLG-2Q500-50
使用介质 Medium	空气、水、油、瓦斯/Air, Water, Oil, Gas					
动作方式 Motion Pattern	直动式/Direct Drive					
流量孔径 (mm) Aperture of Flow Rate	16	20	25	35	40	50
CV值 CV Value	4.8	12	7.6	24	29	48
接管口径 Joint Pipe Bore	1/4" / 1/2"	3/4"	1"	1 1/4"	1 1/2"	2"
使用介质粘度 Operation Fluid Viscosity	50 CST以下(Below)					
使用压力范围 (kgf/cm <sup>2</sup> ) Working-pressure Range	0~7					
最大耐压力 (kgf/cm <sup>2</sup> ) Max. Pressure Resistance	10.5					
控制压力范围 (kgf/cm <sup>2</sup> ) Control Pressure Range	3~6					
工作温度范围 (°C) Operating Temp. Range	-5~100°C					
本体材质 Material of Body	黄铜/Brass					
油封材质 Material of Oil Seal	聚四氟乙烯(PTFE)					
控制接管口径 Control Joint Pipe Bore	2-M5	2-G1/8"	2-G1/8"	2-G1/4"	2-G1/4"	2-G1/4"
气缸型号 Cylinder Model	20	20	32	50	50	63

\*特殊电压及特殊规格请与厂方接洽。 Please contact factory for special voltage and sepcification.

外形尺寸/Oevrral Dimension

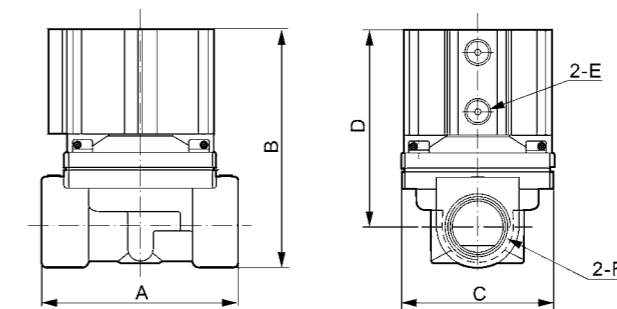

型号 Model	A	B	C	D	E	F
SLG-2Q160-10	66	83	57	70.5	M5	1/4"
SLG-2Q160-15	66	83	57	70.5	M5	1/2"
SLG-2Q200-20	92	108	78	87.5	1/8"	3/4"
SLG-2Q250-25	92	108	78	87.5	1/8"	1"
SLG-2Q350-35	125	125	95	100.5	1/4"	1 1/4"
SLG-2Q400-40	125	131	95	102.5	1/4"	1 1/2"
SLG-2Q500-50	168	152	125	117	1/4"	2"